

MILE MARKER/SELECTRO HUBS CONVERSION KITS LIMITED WARRANTY

Mile Marker, Inc. (M/M-Selectro) warrants directly to the first purchaser of each M/M-Selectro locking hub that the M/M-Selectro locking hub will be free from defects in material and workmanship appearing under normal use and service for as long as said purchaser owns the locking hub. This warranty extends only to the first purchaser. If you discover a covered defect, M/M will, at its option, repair, replace hub parts at no charge to you, provided you remove the hub from the vehicle and return it prepaid to Mile Marker, Inc. Please attach your name, address, phone number and a detailed description of problem relating to malfunction and a copy of a bill of sale, bearing the appropriate M/M serial numbers as warranty service. **To obtain any warranty coverage it is absolutely necessary that you present proof of purchase acceptable to M/M, such as a copy of the purchase receipt.**

Conversion kits warranty for 90 days only. 427, 428, 95-37044 and classic hubs warranty one (1) year only. This warranty applies only to locking hubs manufactured by M/M, which can be identified by the M/M-Selectro trademark, trade name, or logo affixed to them. M/M does not warranty any products that are not M/M products. This warranty does not apply if the product has been damaged by accident, abuse, misuse, collision, overloading, failure of inner or outer bearings, bent wheel or rim, or improperly serviced front axle, misapplication, over lubricating, lack of Loc-tite on cap screws, improperly installed, or has been improperly used, has been improperly serviced or has been modified without the written permission of M/M. This warranty does not apply if any M/M serial number or identification has been removed or defaced. The finish on the product is excluded from this warranty. In addition, commercial or industrial use or applications of the product without the written approval of M/M voids the entire warranty.

Except as expressly stated herein, there are no warranties, expressed or implied including implied warranties of merchantability and fitness for a particular purpose which by law may not be excluded is limited in duration to one (1) year from the date of original retail purchase of this product.

The warranty and remedies set forth above are exclusive and in lieu of all others, oral or written, expressed or implied. No M/M dealer, agent or employee is authorized to make any modification, extension or addition to this warranty.

In no event is M/M responsible for special, incidental or consequential damages resulting from any breach of warranty, or profits, down time, good will, damage to or replacement of equipment and property, loss of use of the product or any associated equipment, or cost of substituted product.

Some states do not allow the exclusion or limitation of incidental or consequential damages or limitation on how long an implied warranty lasts, so the above limitations or exclusions may not apply to you. The warranty gives you specific legal rights, and you may also have other rights, which vary from state to state.

Warranty inquiries should be directed to:

Mile Marker, Inc.
2121 Blount Road
Pompano Beach, FL 33069
PH: 9547820604
FAX: 9547820770

WARRANTY REGISTRATION

This warranty registration must be mailed to Mile Marker within fifteen days of purchase to be valid.

Purchaser _____

Store where purchased _____

Purchaser's address _____

Purchaser's vehicle _____

To Install Hubs, first REMOVE PARTS SHOWN

- Dust Cap
- Snap Ring
- Cap Screw (six)
- Lock Washers
- Drive Flange
- Gasket

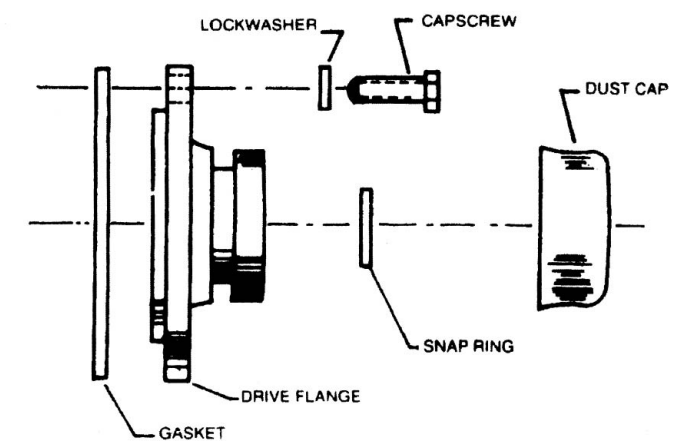

INSTALLATION

1. Remove cap from Body Assembly.
2. Install Hub Body and gasket on wheel using cap screws and lock tabs.
3. Replace Snap Ring.
4. Install cap and gasket with six cap screws.

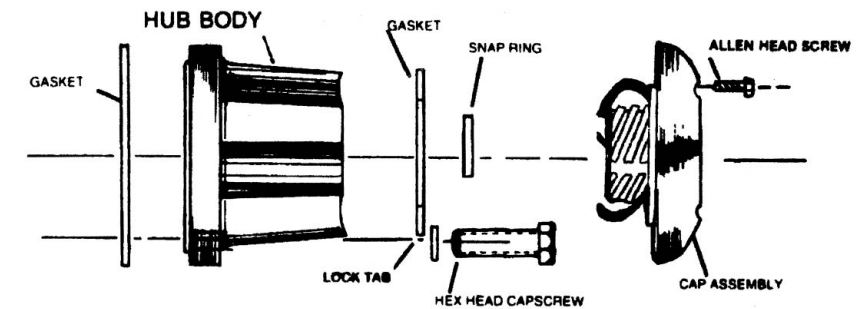

NOTE: When reassembling your hubs, make sure that the spring pin is in alignment with the wide-slot groove. If it does not turn, place it in the other wide-slot groove on the opposite side.

SERVICE INSTRUCTIONS:

Hubs should be serviced at same time as wheel bearings. Clean and coat axle gear bearings with grease. The hubs should never be packed with grease. We recommend checking wheel bearing adjustment and locknut torque to be sure they are within vehicle manufacturer's specifications. Engage hubs one mile monthly.

OPERATING INSTRUCTIONS:

2-WHEEL DRIVE

Both control dials set in free position and transfer case in two-wheel drive.

4-WHEEL DRIVE

Set both hubs to lock and shift transfer case to four-wheel drive. **DO NOT** drive on pavement or other hard surface roads in LOCK, this can result in severe binding up and damage of the gear train.

Never drive with one hub only engaged, this can damage front differential.

Never drive unless the control dials are in either fully locked or fully free position. If the hubs are partially engaged, hub damage may result.



U.S. Patent No. 4.775.040